

DT 23

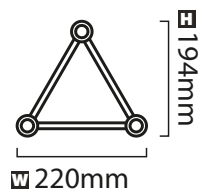

Ø 35mm



DT 23-050

Code: 1723100001 **L** 500mm **KG** 1,4

DT 23-100

Code: 1723100002 **L** 1000mm **KG** 2,4

DT 23-150

Code: 1723100003 **L** 1500mm **KG** 3,6

DT 23-200

Code: 1723100004 **L** 2000mm **KG** 4,7

DT 23-250

Code: 1723100005 **L** 2500mm **KG** 5,7

DT 23-300

Code: 1723100006 **L** 3000mm **KG** 6,8

DT 23-350

Code: 1723100007 **L** 3500mm **KG** 7,8

DT 23-400

Code: 1723100008 **L** 4000mm **KG** 8,9



TECHNICAL DATA

Tube diameter: 35mm x 2mm (1.4 x 0.08 inch)
 Cross brace diameter: 8mm (0.3inch)
 Material: Alloy EN-AW 6082 T6 (AlMgSi1 T6)



LOAD CHART - EN-1090

Compressed chord needs a horizontal support every 1,0 m. (stability request)

Length (m)	2	3	4	6	8	10
Point load (kg)	262	171	127	81	56	41
Deflection (mm)	1,8	4	7,2	16,5	30	48,3
Distrib. load (kg/m)	175	114	64	27	14	8
Deflection (mm)	1,5	4,9	8,9	20,1	36	56,8

LOAD CHART - EN-1090

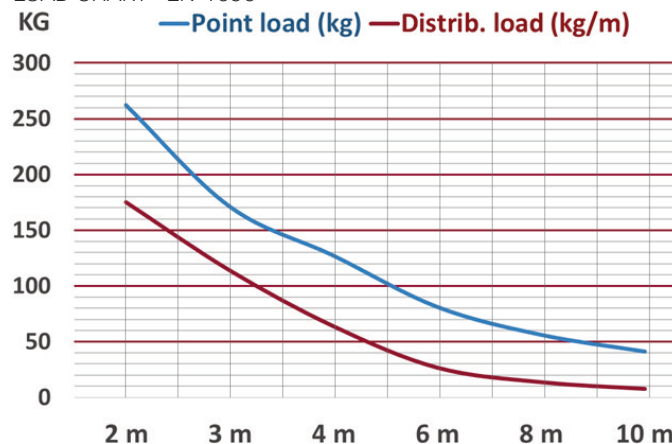

THREE TUBE SYSTEM

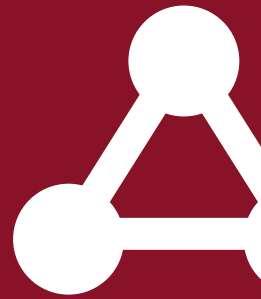

DT 23-C19-L45

CODE: 1723200001

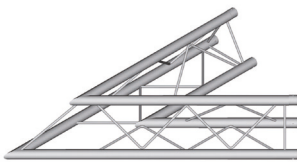

2 way corner
L 1000mm **W** 1000mm **H** 194mm
 ∠ 45° **KG** 3,2

DT 23-C20-L60

CODE: 1723200002

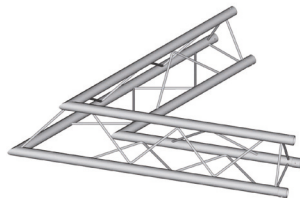

2 way corner
L 1000mm **W** 1000mm **H** 194mm
 ∠ 60° **KG** 3,6

DT 23-C21-L90

CODE: 1723200003

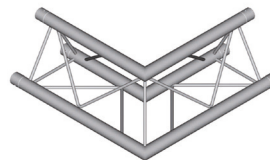

2 way corner
L 500mm **W** 500mm **H** 194mm
 ∠ 90° **KG** 2,1

DT 23-C22-L120

CODE: 1723200004

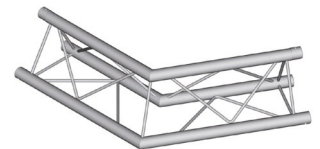

2 way corner
L 500mm **W** 500mm **H** 194mm
 ∠ 120° **KG** 2,2

DT 23-C23-L135

CODE: 1723200005

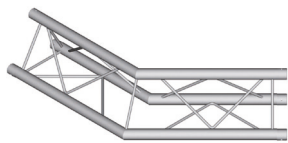

2 way corner
L 500mm **W** 500mm **C** 194mm
 ∠ 135° **KG** 2,4

DT 23-C24-L90

CODE: 1723200006

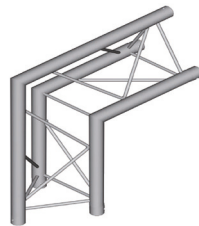

2 way corner 90° apex out
L 500mm **W** 500mm **H** 220mm
 ∠ 90° **KG** 2,0

DT 23-C25-L90

CODE: 1723200007



2 way corner 90° apex in
L 500mm **W** 500mm **H** 220mm
 ∠ 90° **KG** 2,1

DT 23-C31-ULDR

CODE: 1723200008

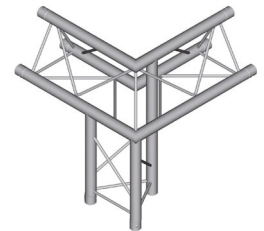

3 way corner 90° apex up right
L 500mm **W** 500mm **H** 5000mm
 ∠ 90° **KG** 3,0

DT 23-C32-ULDL

CODE: 1723200009

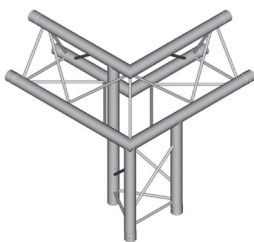

3 way corner 90° apex up left
L 500mm **W** 500mm **H** 500mm
 ∠ 90° **KG** 3,0

DT 23-C33-LD

CODE: 1723200010

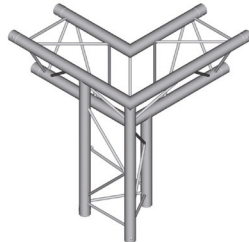

3 way corner 90° apex down right
L 500mm **W** 500mm **H** 500mm
 ∠ 90° **KG** 3,2

DT 23-C34-LD

CODE: 1723200011

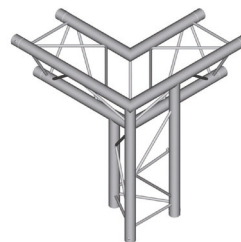

3 way corner 90° apex down left
L 500mm **W** 500mm **H** 500mm
 ∠ 90° **KG** 3,2

DT 23-T35-VD

CODE: 1723200012

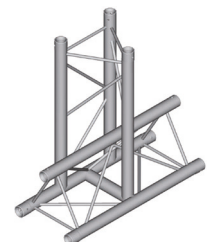

3 way T-joint apex down vertical
L 500mm **W** 220mm **H** 500mm
 ∠ 90° **KG** 2,5

DT 23-T36H

CODE: 1723200013

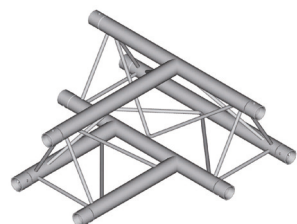

3 way T-joint horizontal
L 500mm **W** 500mm **H** 194mm
 ∠ 90° **KG** 2,4

DT 23-T37V

CODE: 1723200014

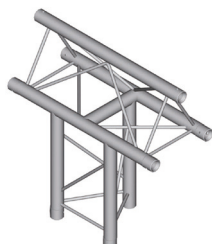

3 way T-joint apex up vertical
L 500mm **W** 500mm **H** 220mm
 ∠ 90° **KG** 2,5

DT 23-C41

CODE: 1723200015

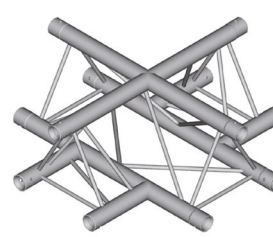

4 way X-joint
L 500mm **W** 500mm **H** 194mm
 ∠ 90° **KG** 2,7

DT 23-T42-DTD

CODE: 1723200016

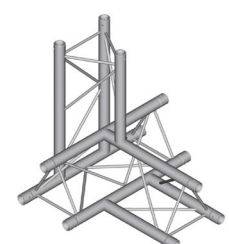

4 way T-joint + down
L 500mm **W** 500mm **H** 500mm
 ∠ 90° **KG** 3,0

DT 23

DT 23-T43-UTD

CODE: 1723200017

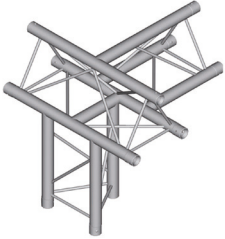

4 way T-joint + up

L 500mm **W** 500mm **H** 500mm
KG 3,0

DT 23-C44-LUD

CODE: 1723200018

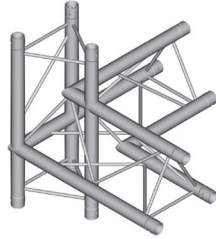

4 way corner 90° + up + down right

L 500mm **W** 500mm **H** 500mm
KG 3,0

DT 23-C45-LUD

CODE: 1723200019

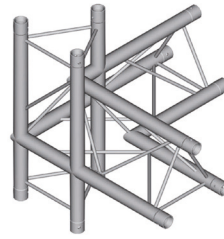

4 way corner 90° + up + down left

L 500mm **W** 500mm **H** 500mm
KG 3,0

DT 23-T51-TUD

CODE: 1723200020

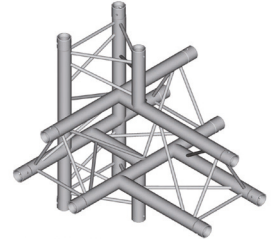

5 way T-joint + up + down

L 500mm **W** 500mm **H** 500mm
KG 3,8

DT 23-C52-XU

CODE: 1723200021

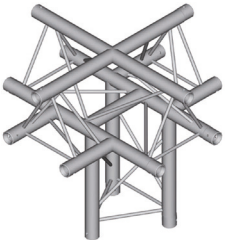

5 way X-joint + up

L 500mm **W** 500mm **C** 500mm
KG 3,5

DT 23-C53-XD

CODE: 1723200022

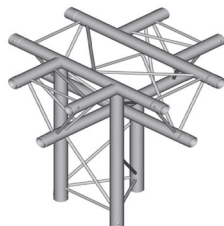

5 way X-joint + down

L 500mm **W** 500mm **H** 500mm
KG 3,5

DT 23-C24R-L90

CODE: 1723200071

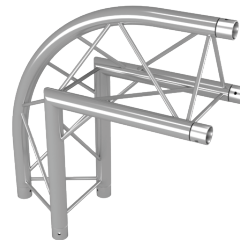

2 way rounded corner 90°

L 500mm **W** 500mm **H** 220mm
KG 1,5

DT 23-C25R-L90

CODE: 1723200070

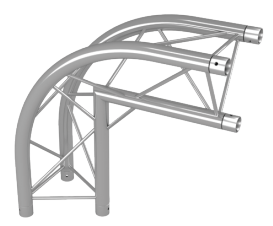

2 way rounded corner 90°

L 500mm **W** 500mm **H** 220mm
KG 1,7

DT 23-BPM

CODE: 1723400003

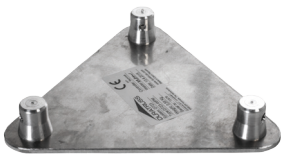

base plate male

L 240mm **W** 212mm **H** 5mm
KG 1,0

DT 23-WPM

CODE: 1723400004

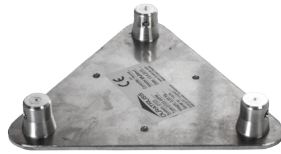

wall plate male

L 240mm **W** 212mm **H** 5mm
KG 1,0

DT BPS-4040

CODE: 1720000005



for DT 23 & DT 31

Material: steel | incl. half connectors

L 400mm **W** 400mm **H** 10mm
KG 12,2

DT 20-CC

CODE: 1723400015



for DT 22 -> 24

DT 20-STEEL PIN

CODE: 1723400016



for DT 22 -> 24

DT 20/40-SAFETY CLIP

CODE: 1744000010

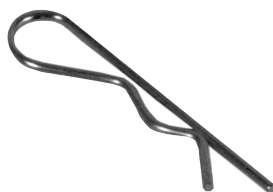

for DT 22 -> 44

DT 20-HCC

CODE: 1749000018

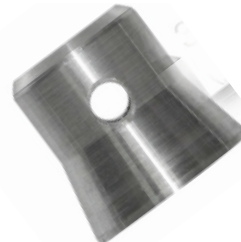

for DT 22 -> 24

DT 20-TERMINAL PIECE

CODE: 1722400005



for DT 22 -> 24